

4

3

2

1

B

B

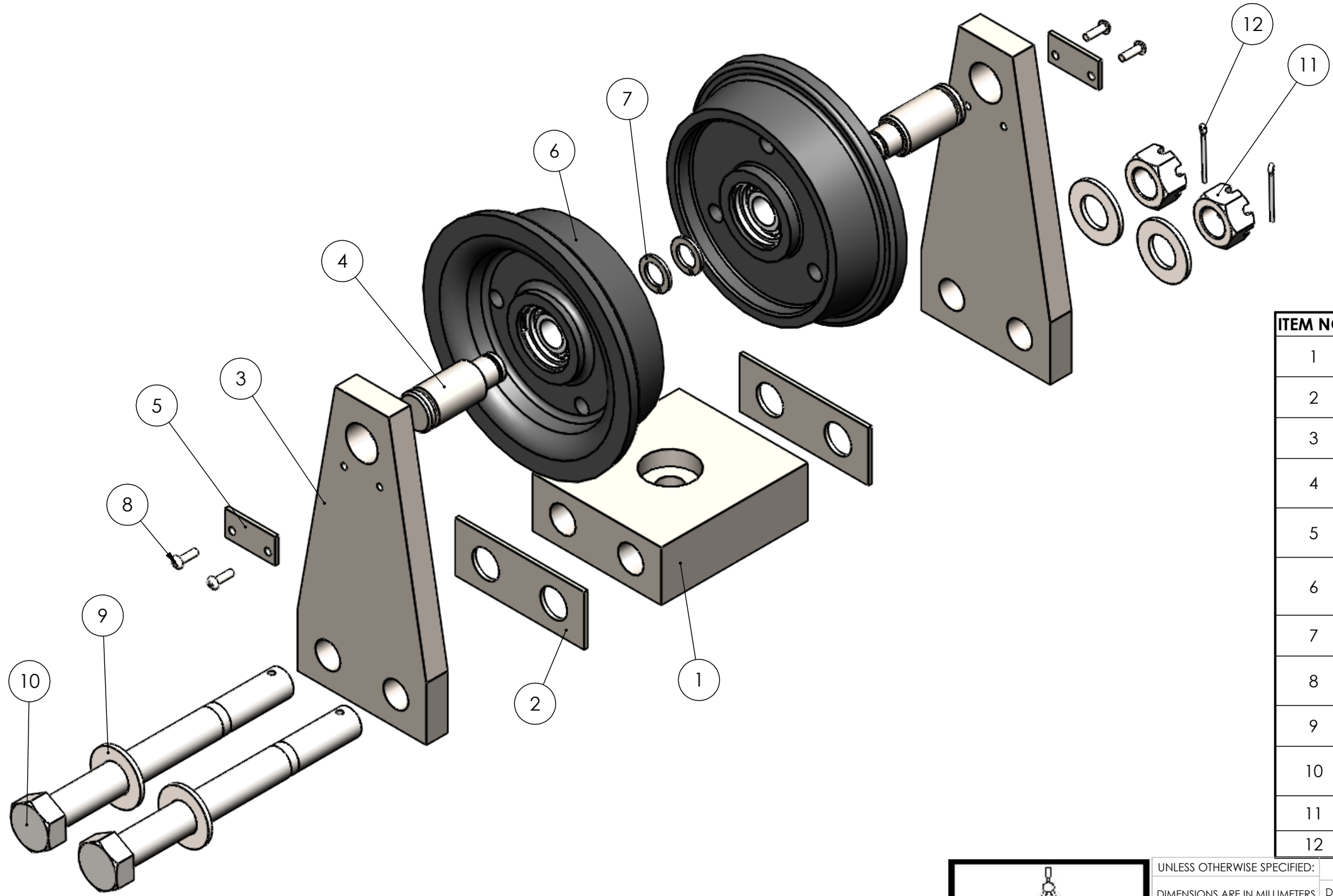

ITEM NO.	PART NUMBER	DESCRIPTION	MATERIAL	QTY.
1	CROSS HEAD	CROSS HEAD BASE	HOT ROLLED STEEL	1
2	ADJUSTING SHIM	BASE ADJUSTING SHIM	HOT ROLLED STEEL	2
3	SIDE PLATES	TROLLEY SIDE PLATE	HOT ROLLED STEEL	2
4	AXLE	TROLLEY AXLE	COLD ROLLED STEEL	2
5	KEEPER PLATE	AXLE KEEPER PLATE	COLD ROLLED STEEL	2
6	TROLLEY_WHEEL_ASM	TROLLEY WHEEL WITH BALL BEARING	CAST IRON AND ALLOYS	2
7	AXLE_SNAPRING	SNAP RING FOR AXLE	SPRING STEEL	2
8	CR-RHMS 0.19-24X0.625X0.625-C	ROUND HEAD MACHINE SCREW	STEEL	4
9	PREFERRED NARROW FW 0.875	PLAIN WASHER	STEEL	4
10	HEX_BOLT	HEX BOLT WITH COTTER PIN HOLE	STEEL	2
11	HSNUT 0.8750-14-D-C	HEX SLOTTED NUT	STEEL	2
12	COTTER PIN	COTTER PIN	STEEL	2

A

A

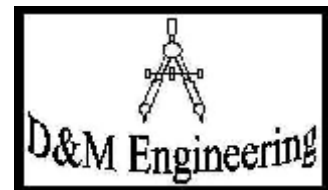

PROPRIETARY AND CONFIDENTIAL
 THE INFORMATION CONTAINED IN THIS DRAWING IS THE SOLE PROPERTY OF <INSERT COMPANY NAME HERE>. ANY REPRODUCTION IN PART OR AS A WHOLE WITHOUT THE WRITTEN PERMISSION OF <INSERT COMPANY NAME HERE> IS PROHIBITED.

UNLESS OTHERWISE SPECIFIED:
 DIMENSIONS ARE IN MILLIMETERS
 TOLERANCES:
 ANGULAR: MACH ± 0° 30'
 ONE PLACE DECIMAL ± 0.5
 TWO PLACE DECIMAL ± 0.15
 INTERPRET GEOMETRIC TOLERANCING PER: ASME Y14.5
 MATERIAL AS SHOWN
 FINISH AS SHOWN

	NAME	DATE
DRAWN	QN	12/1/2021
CHECKED		
ENG APPR.		
MFG APPR.		
Q.A.		
COMMENTS:		

D&M ENGINEERING
 TITLE:
Trolley Assembly
 SIZE DWG. NO. REV
B TROLLEY ASM
 SCALE: 1:3 WEIGHT: SHEET 1 OF 1

4

3

2

1