

| REVISIONS | | | |
|-----------|--------------------|-----------|----------|
| REV. | DESCRIPTION | DATE | APPROVED |
| 0 | PRODUCTION RELEASE | 5/12/2022 | RJM |

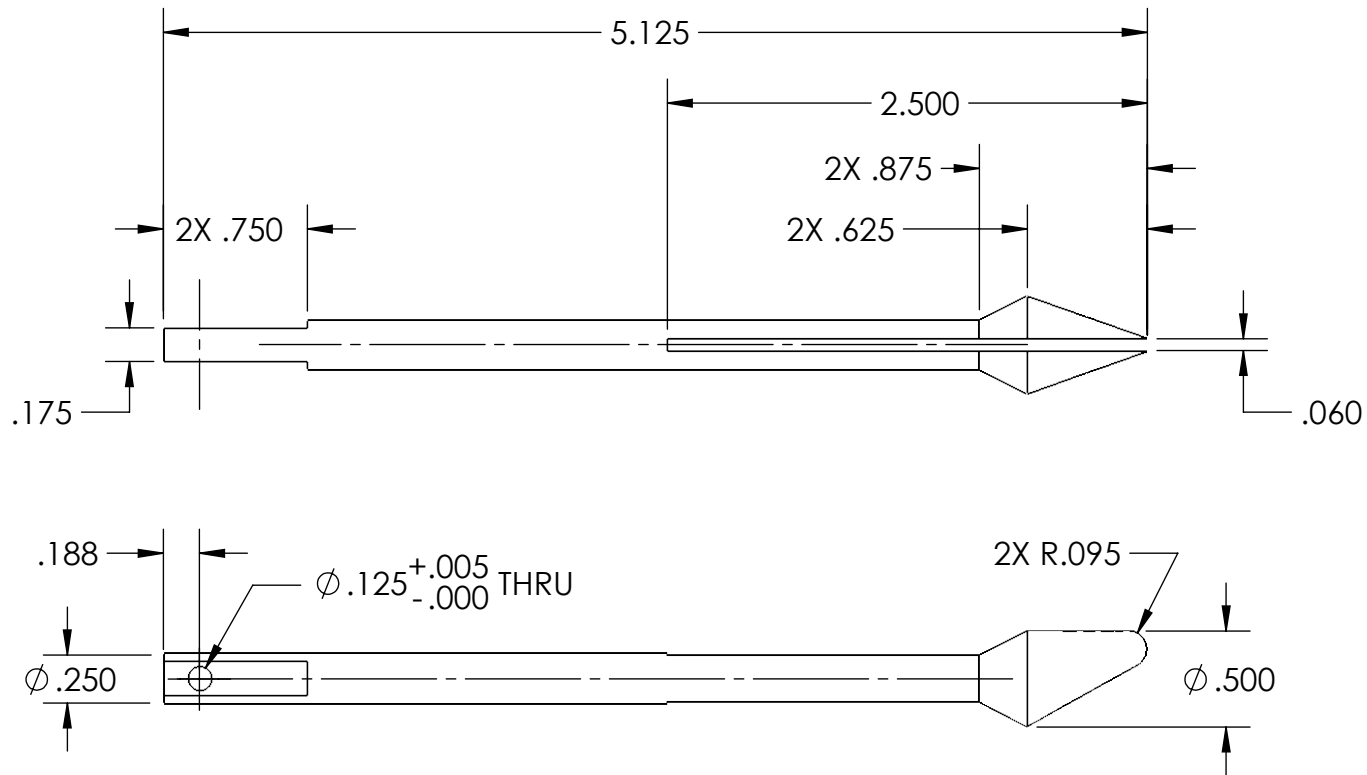

HENNEPIN TECHNICAL COLLEGE
BROOKLYN PARK & EDEN PRAIRIE, MN

TITLE
JAW SHAFT

UNLESS OTHERWISE SPECIFIED:
 DIMENSIONS ARE IN INCHES
 TOLERANCES:
 ANGULAR: $\pm .5^\circ$
 ONE PLACE DECIMAL: $\pm .03$
 TWO PLACE DECIMAL: $\pm .01$
 THREE PLACE DECIMAL: $\pm .005$
 FOUR PLACE DECIMAL: $\pm .0005$
 INTERPRET GEOMETRIC TOLERANCES
 PER ASME Y14.5-2009

| | NAME | DATE |
|------------------------|----------|-----------|
| DRAWN | QN | 4/16/2022 |
| CHECKED | RJM | 4/16/2022 |
| MATERIAL | SAE 1060 | |
| THIRD-ANGLE PROJECTION | | |

| SIZE | DWG. NO. | REV |
|------------|----------|--------------|
| A | 1DT1006 | 0 |
| SCALE: 1:1 | WEIGHT: | SHEET 1 OF 1 |